

RoHS Compliant
Made in China

Features

- Compact 9mm design
- Carbon element
- Ganging up to 12 sections available
- Audio taper option
- Tracking error within 2dB
- Adjusting shaft type is rich

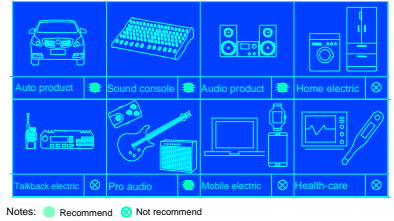

Notes: ● Recommend ○ Not recommend

RV97 Series-9.5mm Sealed Insulation Shaft Rotary Potentiometer

How To Order

RV97P0G0-TB10B7.0-B503-0000

A B C D E F G H I J

A Rotary Potentiometer Model:97
 C PC Pin Vertical/Terminal Size
 D Switch Configuration
 G0=No Switch GS=Rotary Switch
 F Standard Shaft Length"L"
 H Installation Dimension"A"
 I Resistance Curve and Resistance Value

B Bushing Specification"W"
 P=1.5 C=4.0 R=5.0
 E Shaft Style
 G Shaft Materials
 B=Black Insulation Shaft
 H=Gary Insulation Shaft
 J=Golden Insulation Shaft
 T=Pellucid Insulation Shaft
 J Serial number

Resistance Curve To See:Tapers

Code	501	102	103	253	503	104	105
Value	500Ω	1KΩ	10KΩ	25KΩ	50KΩ	100KΩ	1MΩ

Mechanical Characteristics

Total Rotational Angle.....300°±10°
 Shaft Stopper Strength.....3Kgf.cm min.
 Shaft Wobble.....0.5 x L/20mm p-p max.

Rotational Torque.....10 to 150gf.cm
 Shaft Push-Pull Strength.....5Kgf 10s min.
 Soldering Condering.....
 Manual Soldering.....96.5 Sn/3.0 Ag/0.5 Cu Sold Wire Or No-clean Rosin Cored Wire 280 °C Max.For 3 Seconds
 Wave Soldering.....96.5 Sn/3.0 Ag/0.5 Cu Solder With No-clean Flux 260 °C Max.For 5 Seconds
 Wash Process.....Not Recommended

Electrical Characteristics

Standard Resistance Range.....200Ω To 2MΩ
 Maximun Operating Voltage.....150 VAC,20 VDC
 Noise.....100 mV max.
 Voltage proof.....300V AC for 1 minute.
 Insulation resistance.....100MΩ min. 250V DC
 Residual Resistance.....20 Ω max.

Total Resistance Tolerance.....±10 Or ±20%
 Rated Power.....
 Linear Taper.....0.05 Watts
 Audio Taper.....0.025 Watts
 Tracking Error(-40 dB To 0 dB).....±3 dB
 Higher Requirements Need To Be Customized.....

Environmental Characteristics

Operating Temperature Range.....-10 to +70
 Storage Temperature Range.....-40 to +85

Sealability(Optional).....IP40 or IP67

Durability Characteristics

Rotational Life.....10,000 cycles

Tapers

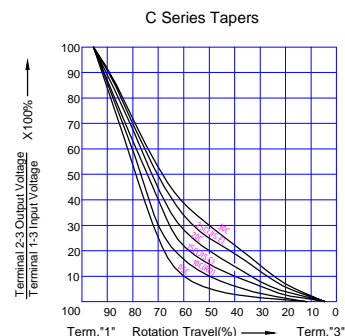
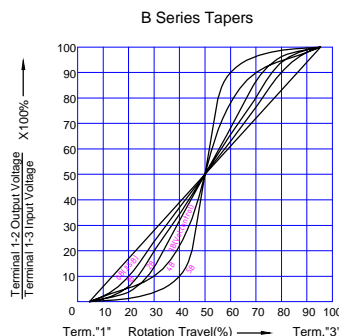
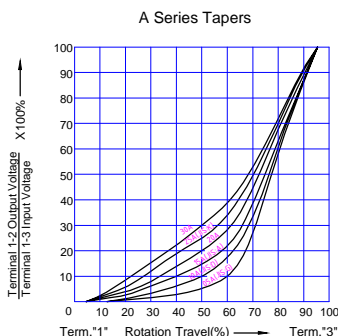

Product Dimensions

Unit:mm

RV97P0G0

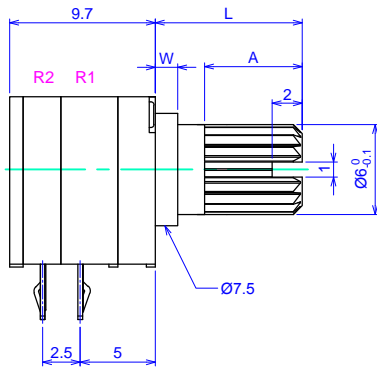

Shaft shown in full CCW position

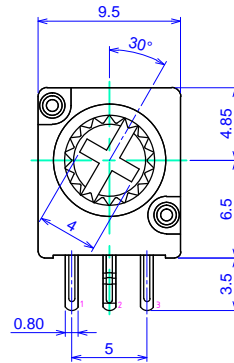

PC board mounting hole dimensions (Viewed from mounting side)

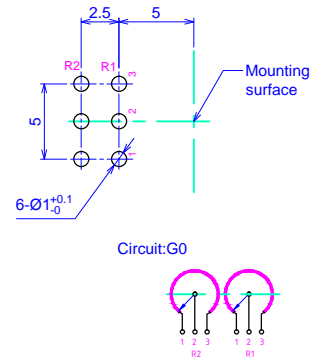

RV97P4G0

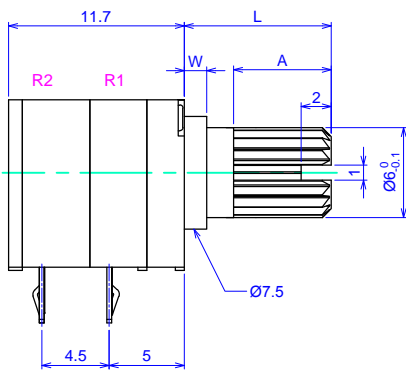

Shaft shown in full CCW position

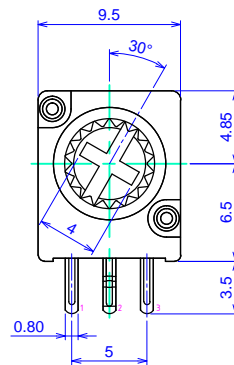

PC board mounting hole dimensions (Viewed from mounting side)

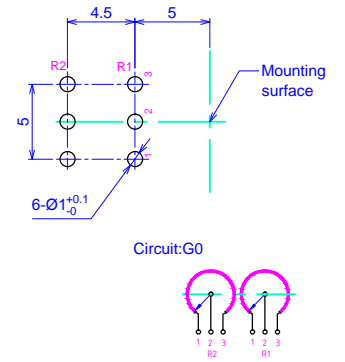

RV97C5G0

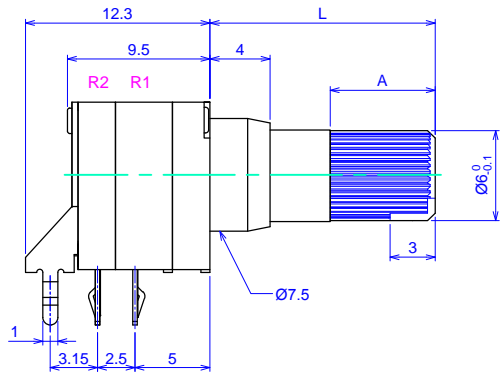

Shaft shown in full CCW position

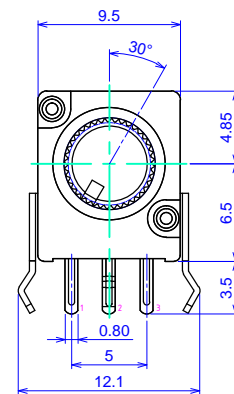

PC board mounting hole dimensions (Viewed from mounting side)

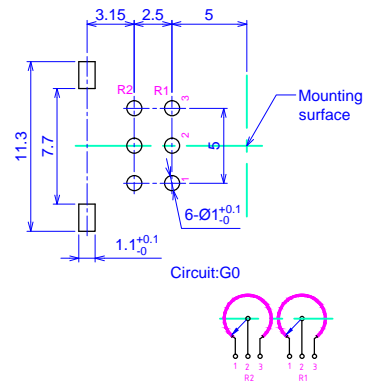

RV97P2G0

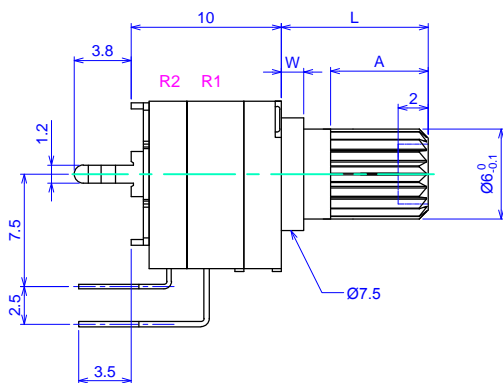

Shaft shown in full CCW position

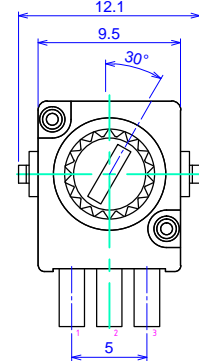

PC board mounting hole dimensions (Viewed from mounting side)

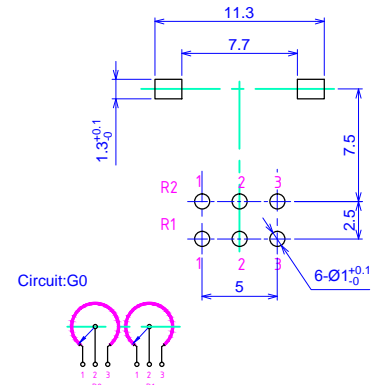

Product Dimensions

Unit:mm

RV97R0GS
(Rotary switch)

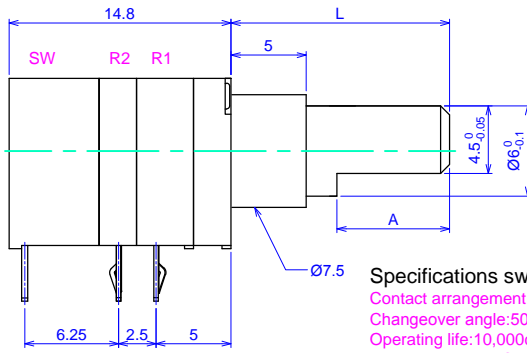

Shaft shown in full CCW position

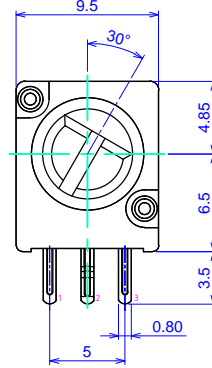

PC board mounting hole dimensions
(Viewed from mounting side)

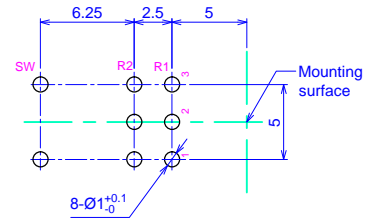

Circuit:GS

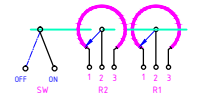

Specifications switches:

- Contact arrangement:SPST
- Changeover angle:50° max.
- Operating life:10,000cycles
- Ratings:3A 16V DC
- Contact resistance:100mΩ max.

RV97R2GS
(Rotary switch)

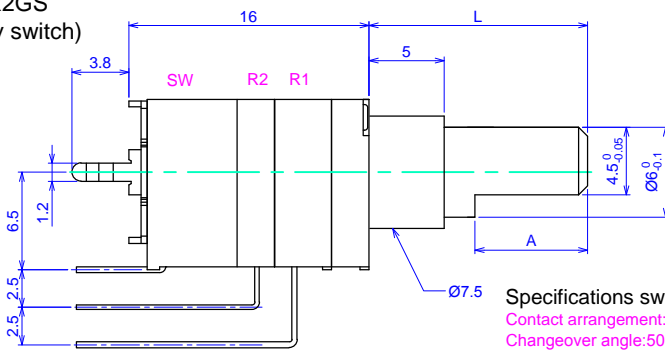

Shaft shown in full CCW position

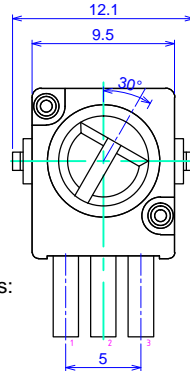

PC board mounting hole dimensions
(Viewed from mounting side)

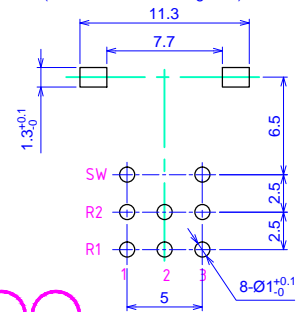

Circuit:GS

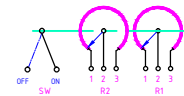

Specifications switches:

- Contact arrangement:SPST
- Changeover angle:50° max.
- Operating life:10,000cycles
- Ratings:3A 16V DC
- Contact resistance:100mΩ max.

Bushing Type

Unit:mm

A:

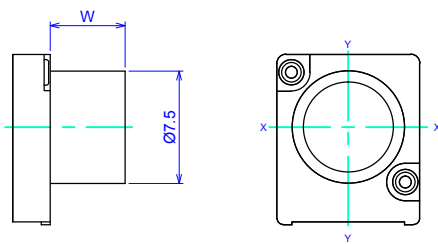

W	1.5	5.0	
□	P	R	

B:

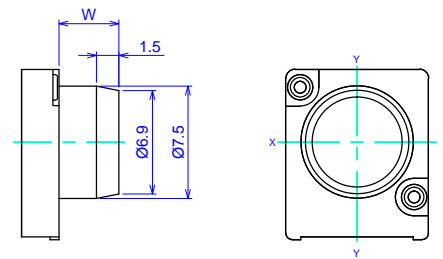

W	4.0		
□	C		

◆ Notes:

- Normal color for bushing is black.
- Bushing length and color can be customized.
- The bushing type shown are normal, if special bushing type needed, please contact with us.
- Material for bushing is PC, if need other material please contact with us.

Product Dimensions

Unit:mm

RV9784G0
(Tamper-proof)

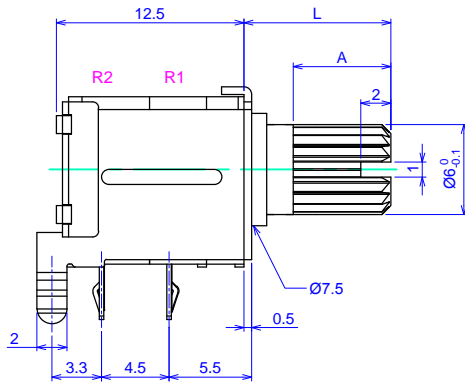

Shaft shown in full CCW position

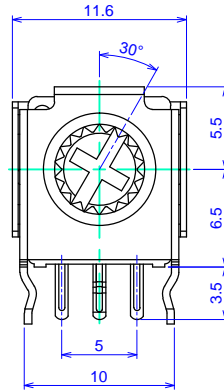

PC board mounting hole dimensions
(Viewed from mounting side)

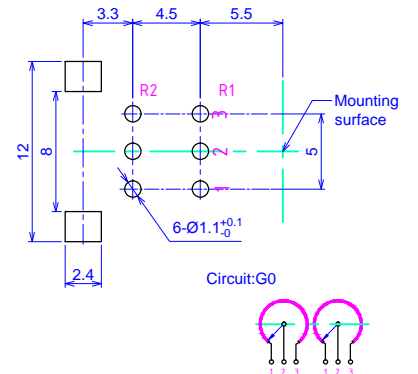

RV97PBG0(H=10.0)
RV97PDG0(H=12.5)

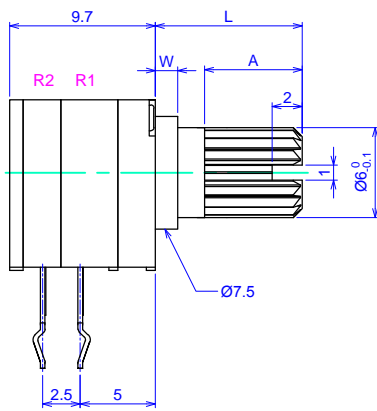

Shaft shown in full CCW position

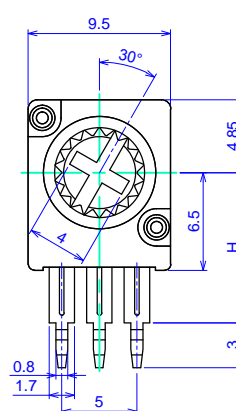

PC board mounting hole dimensions
(Viewed from mounting side)

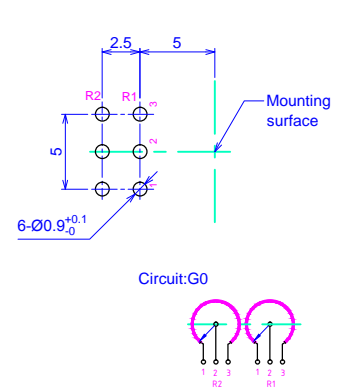

RV97PFG0

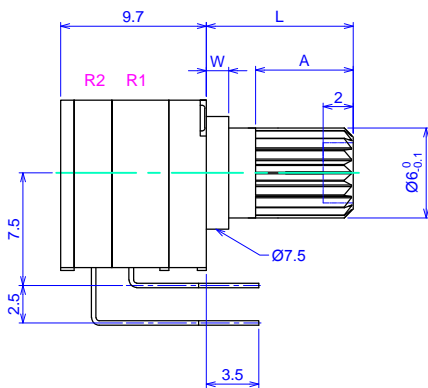

Shaft shown in full CCW position

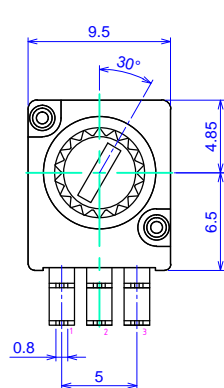

PC board mounting hole dimensions
(Viewed from mounting side)

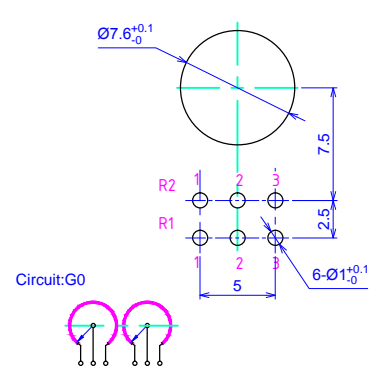

RV97P0G0(LED)

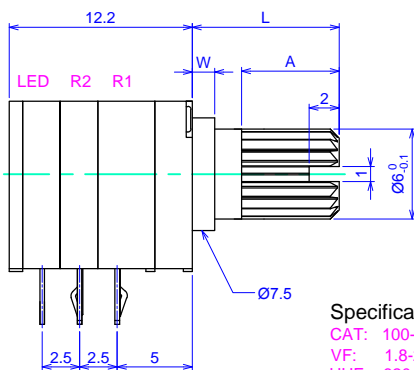

Shaft shown in full CCW position

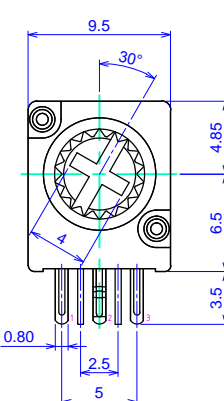

PC board mounting hole dimensions
(Viewed from mounting side)

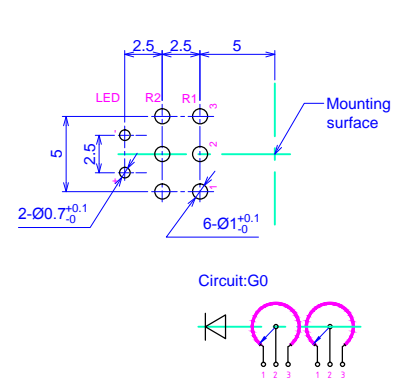

Specifications LED:
CAT: 100-400mcd
VF: 1.8-2.2V
HUE: 620-630nm
TIME: 30Khour

Shaft Specifications

Unit:mm

TB/TD-Shaft Type		Detail Dimensions		TS-Shaft Type		Detail Dimensions	
TB-Shaft		TD-Shaft		TS-Shaft			
L	6.5	9.5	10.5	14.5	19.5		
A	4.5	7.0	7.0	7.0	7.0		
TC/TR-Shaft Type		Detail Dimensions		TA-Shaft Type		Detail Dimensions	
TC-Shaft		TR-Shaft		TA-Shaft			
L	6.5	9.5					
A	4.5	7.0					
TG/TJ-Shaft Type		Detail Dimensions		SR-Shaft Type		Detail Dimensions	
TG-Shaft		TJ-Shaft		SR-Shaft			
L	6.5	9.5	14.5				
A	4.5	7.0	7.0				
SB-E/Y-Shaft Type		Detail Dimensions		FA-Shaft Type		Detail Dimensions	
SB(L)E-Shaft		SB(L)Y-Shaft		FA-Shaft			
L	10	15					

◆ Notes:

- Normal color for shaft is black.
- Shaft length and color can be customized.
- The shaft type shown are normal, if special shaft type needed, please contact with us.
- Material for shaft is PC, if need other material please contact with us.